

Suhr[®]

Riot
Mini

User Guide



Table of Contents

Overview	3
Getting Connected	4
Controls	4
Sample Settings	5
Technical Specifications	6
Warranty	6



Thank you for purchasing the Suhr Riot Mini™ Distortion Pedal.

Please take the time to read this manual to get the most out of the Riot Mini. The more you familiarize yourself with the features of this pedal, the more you will enjoy its benefits and maximize its potential.

Overview

Riot is a versatile high-gain distortion pedal with the sonic characteristics and touch sensitivity of a high quality 100 watt tube amplifier. Riot will transform a super clean amp into an authoritative rock tone that inspires all of your favorite riffs.



Getting Connected

- 1 **Input:** Plug the cable from your guitar into here, or from the previous effect's output.
- 2 **Output:** Plug a cable from here to an amp or another effect's input.
- 3 **DC Input:** Riot mini accepts power from power supplies in the range of 9 to 18 Vdc (center negative) ***See Technical Specifications on pg 6.***
- 4 **Foot Switch:** Push on the foot switch to engage or bypass the effect. The blue LED will illuminate when the effect is on.

Controls

Distortion: Adjusts the amount of gain added to your tone, taking you from classic crunch to high gain heaven

Level: Adjusts the output volume of the pedal. Riot mini provides enough volume to push the front end of any tube amp into natural overdrive.

Tone: Shapes the overall tonal response of the pedal - from smooth and warm to cutting lead tones.

Voice: The voice switch selects the two most popular diode selections from the original Riot.

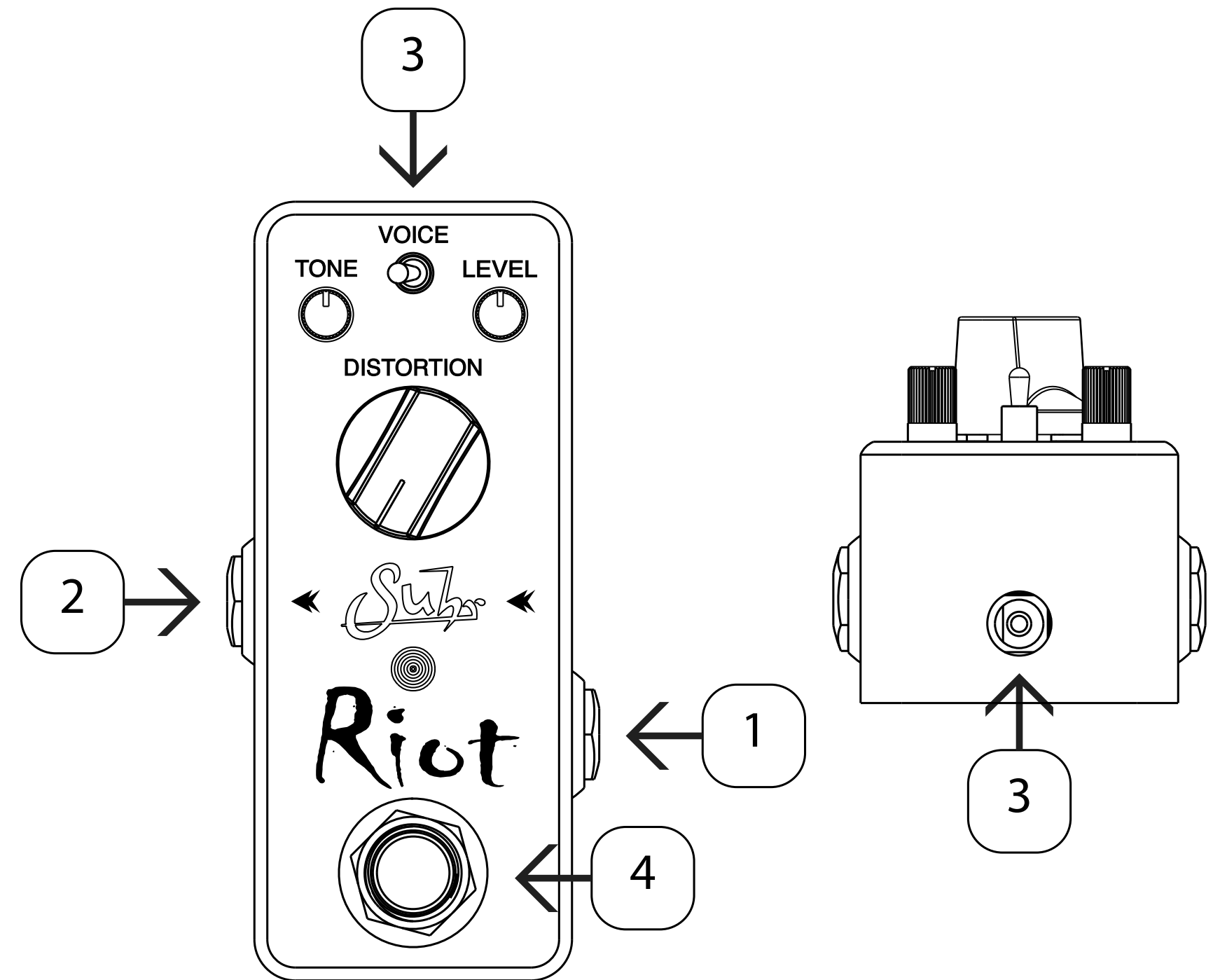

Sample Settings

Classic Crunch

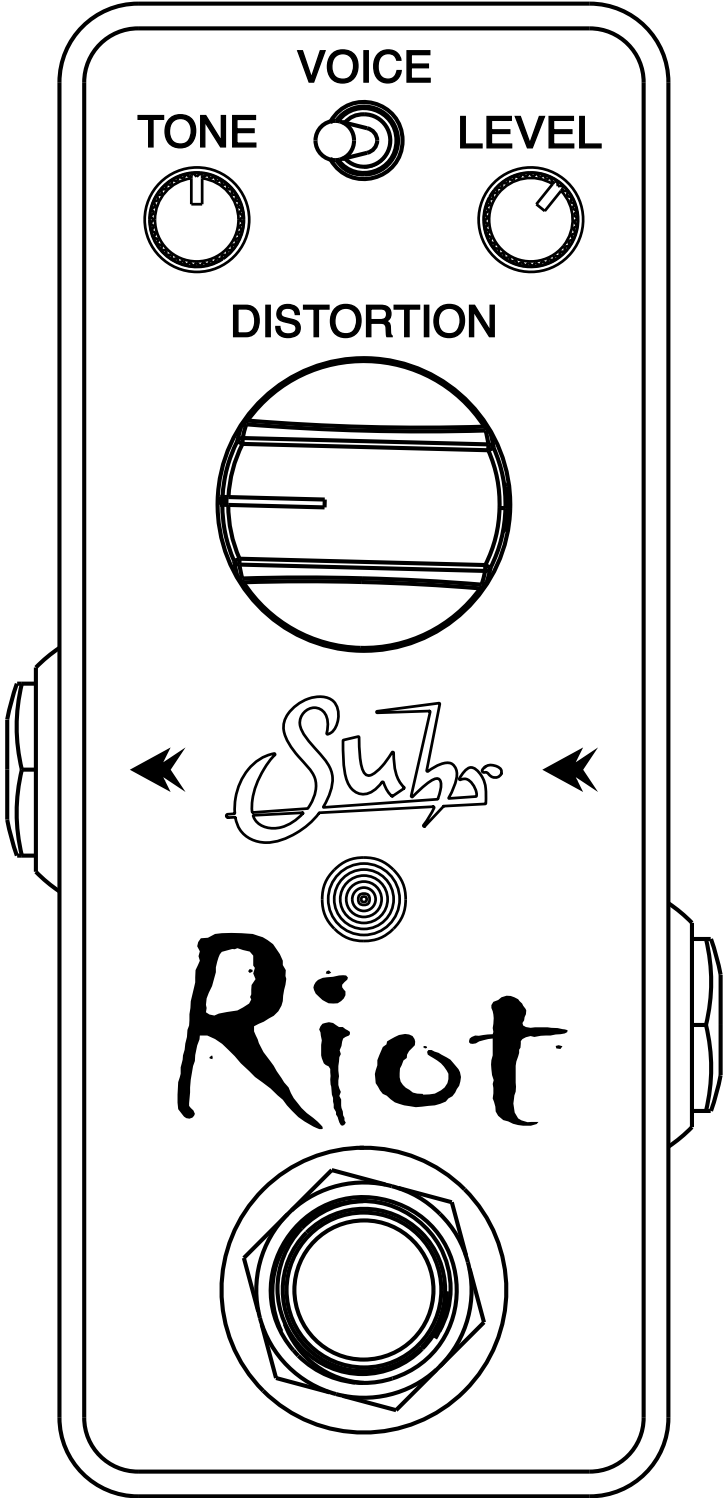

Modern Rock Rhythm

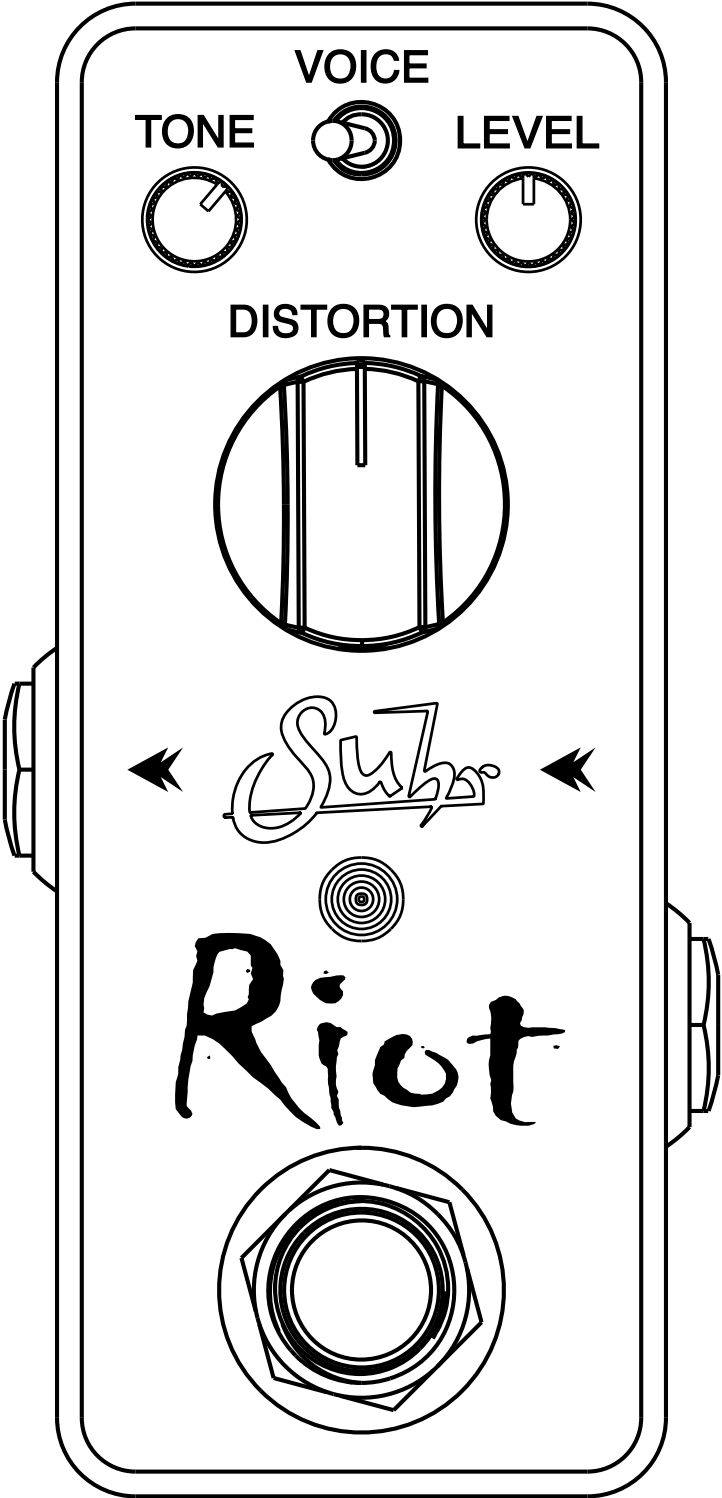

Vintage High Gain

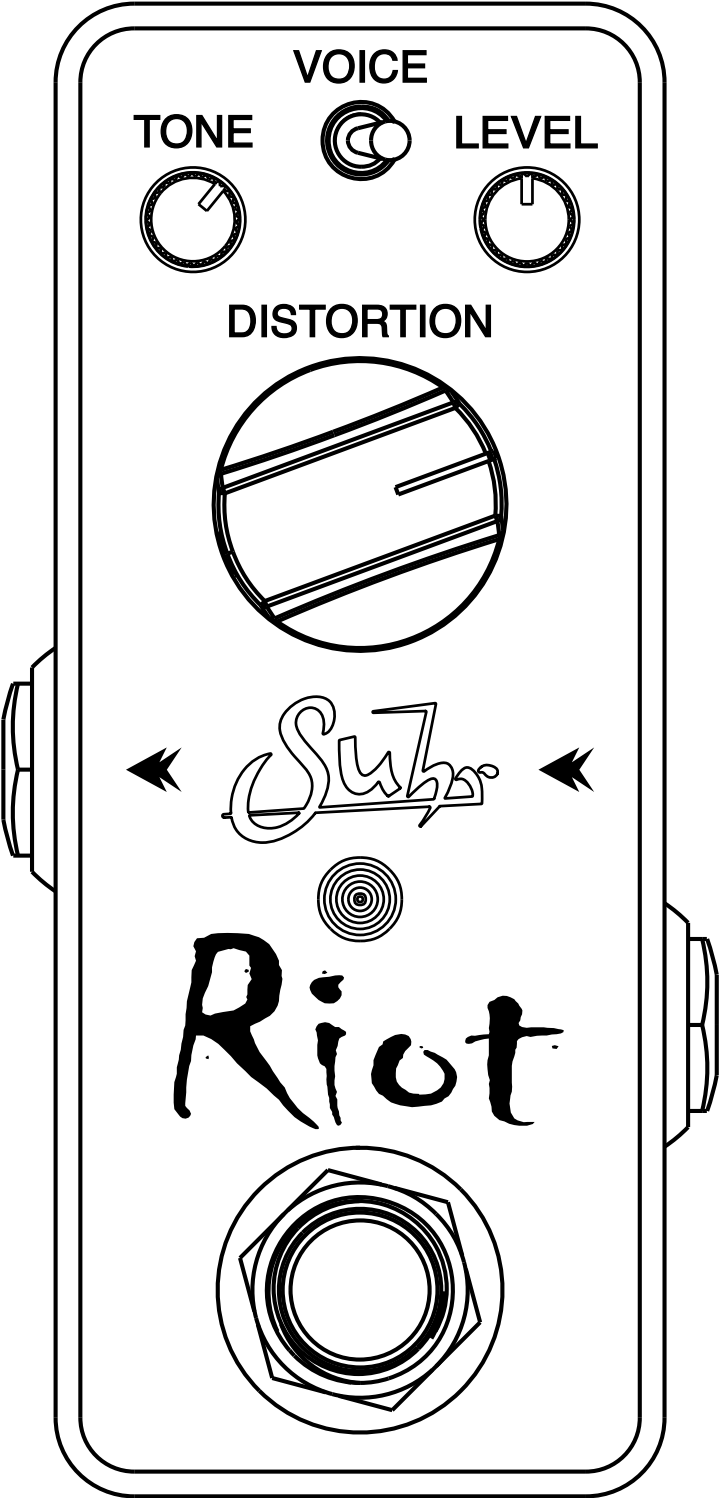

Technical Specifications

Input Impedance:	1M Ohm
Output Impedance:	600 Ohm
Power Connector:	Center Negative, 2.1mm x 5.5mm
Operating voltage:	4V to 18V (nominal 9V)
Maximum Voltage:	20 Vdc
Reverse Battery Protection:	Yes
Over Voltage Protection:	Yes
Current Consumption:	8mA
Dimensions:	1.82”(W) x 3.85”(D) x 1.89”(H)
Weight:	0.365lb
ROHS Compliant:	Yes

Warranty

JS Technologies, Inc. (JST) warrants for lifetime from date of purchase by the initial retail purchaser that this product shall be free from defects in workmanship. Electronic components such as capacitors, resistors, filters, transformers, jacks, and pots are covered for 5 years. Any parts determined defective by JST within the five (5) year term shall be repaired or replaced by JST without charge for parts and labor provided the unit is returned, transportation costs prepaid, to JS Technologies, Inc., 601 Crane Street, Unit A, Lake Elsinore, CA 92530, or to such facility authorized by JST. JST will pay shipping costs to return the unit to its owner. Defects in workmanship will be determined by JST for limited lifetime coverage.

This warranty does not cover damage caused by accident, misuse, abuse, neglect, unauthorized or improperly performed repairs, alterations, and/or wear and tear occasioned by use of the product, and does not include any expense for inconvenience or loss of use while the product is being repaired or replaced. JST expressly disclaims any liability for consequential damages arising from the sale, use, or inability to use the product. Any warranty implied by law, including any warranty of merchantability or fitness, is expressly limited to the one (5) year warranty term for the parts on our amplifiers and electronic products. The foregoing statements of warranty are exclusive and in lieu of all other remedies. Workmanship lifetime warranty is limited strictly to the original retailer purchaser of the instrument registered with JST within 10 days of purchase from an authorized JST dealer or distributor. JST will pay shipping costs to return the unit to its owner within the mainland U.S.

The above warranty policy only applies to customers in USA. If you are an international customer, please check with your distributor and the dealer in your country for warranty matters. Warranty issues must be handled through your dealer or distributor. If you are an international customer who purchased (or plan to purchase) from a US dealer, we can handle warranty matters direct but you will be responsible for shipping both ways. We encourage international customers to purchase through your local distributor or dealer for this reason. Our international distributors are set up to handle warranty issues in their respective countries. If you do not have an authorized Suhr dealer in your country, please contact us direct for further details.

NOTE: This product has been tested and found to comply with the limits for a Class A digital device pursuant to Part 15 of the FCC Rules. These limits are designed to provide reasonable protection against harmful interference when the equipment is operated in a commercial environment. This product generates, uses, and can radiate radio frequency energy and, if not installed and used in accordance with the manufacturer's instruction manual, may cause harmful interference with radio communications. Operation of this product in a residential area is likely to cause harmful interference, in which case you will be required to correct the interference at your own expense.

This device complies with Part 15 of the FCC Rules. Operation is subject to the following two conditions: 1) This device may not cause harmful interference. 2) This device must accept any interference received, including interference that may cause undesired operation.

Notice: The FCC regulations provide that changes or modifications not expressly approved by J.S. Technologies Inc. could void your authority to operate this equipment.

These limits are designed to provide reasonable protection against harmful interference in a non-residential installation. However, there is no guarantee that interference will not occur in a particular installation. If this equipment does cause harmful interference with radio or television reception, which can be determined by turning the equipment off and on, you are encouraged to try to correct the interference by one or more of the following measures:

- **Reorient or relocate the antenna of the radio/television receiver.**
- **Increase the separation between this equipment and the radio/television receiver.**
- **Plug the equipment into a different outlet so that the equipment and the radio/television receiver are on different power mains branch circuits.**
- **Consult a representative of J.S. Technologies Inc. or an experienced radio/television technician for additional suggestions.**